

50mm BALL knob on square rose

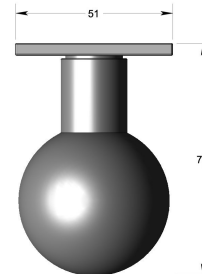

Product image



Dimensions drawing (DIM)

Reference

FKN001 SR4 SPVDBK

Finish

Incasa satin PVD black

Material

Stainless steel 316

Shape

SR4

Description

Solid mortice knob
 Concealed fixing
 High performance bearing rose
 Back to back fixings
 Conforms to EN1906 high usage
 Suitable for use on fire doors