

Cupronickel T-bar return lever handle 19mm dia
on round rose

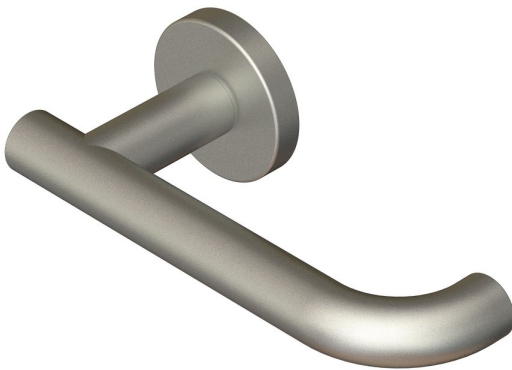

Product image

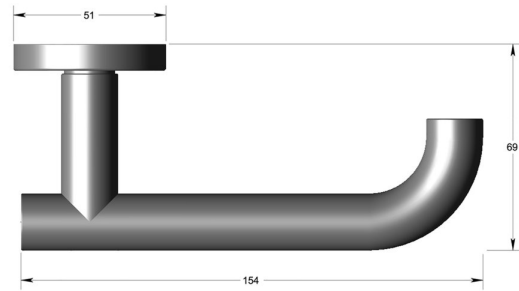

Dimensions drawing (DIM)

Reference

FL108 RR9 SCuNi

Material

Cupronickel

Shape

RR9

Description

Solid lever handle
Concealed fixing
High performance bearing rose
Back to back fixing
Conforms to EN1906 high usage
Suitable for use on fire doors